

PIVOTICA PRO E

FM (FLOOR MOUNTED)

100 F0 | 100 F90

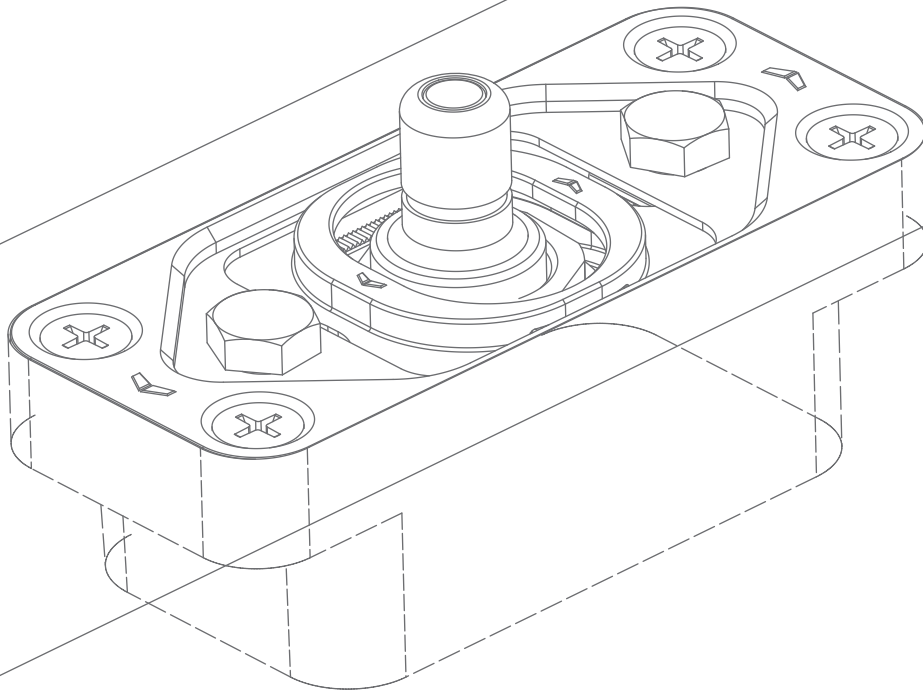

BENODIGDHEDEN / OUTILLAGE / TOOLS / WERKZEUG / MATERIAL NECESARIO

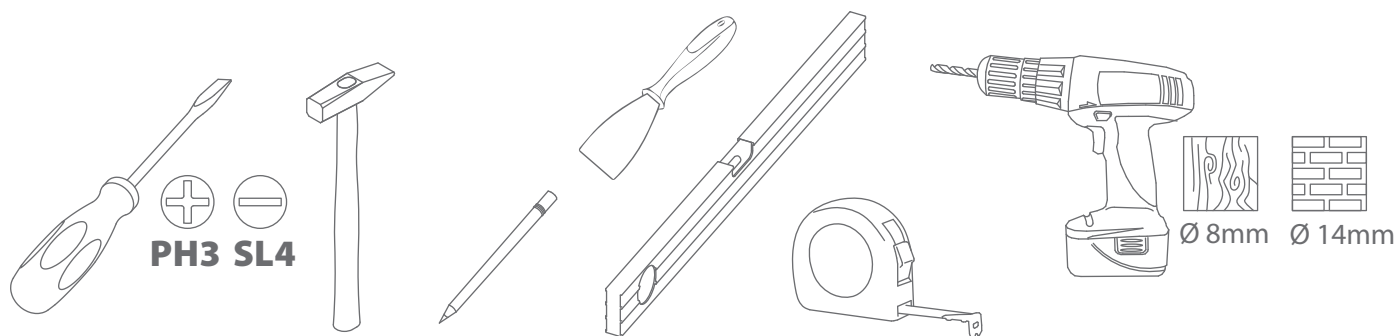

ONDERDELEN / ACCESSOIRES / COMPONENTS / BESTANDTEILE / COMPONENTES

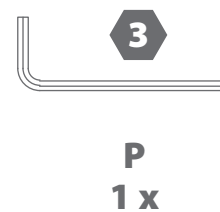
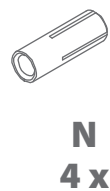
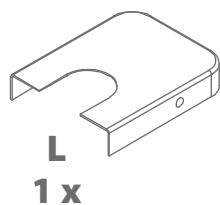
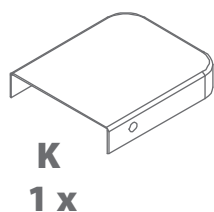
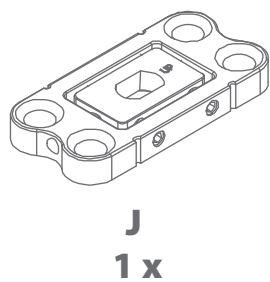
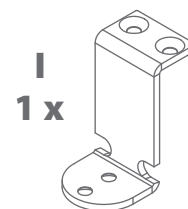
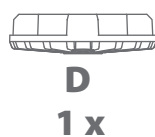
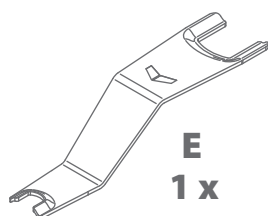
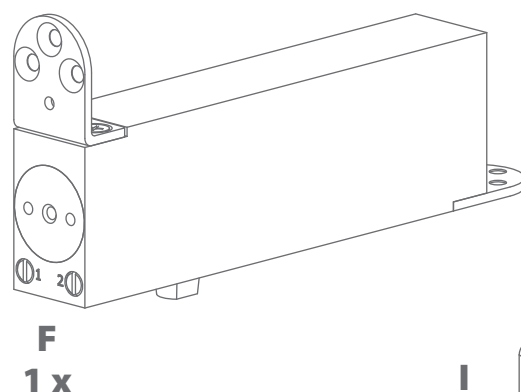
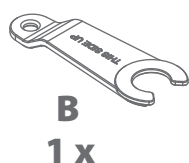
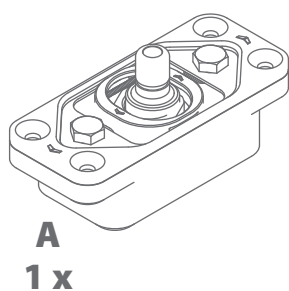

HOEKOPSTELLING / INSTALLATION DANS L'ANGLE DE LA PORTE /
 INSTALLATION ON THE FRONT EDGE OF THE FLOOR / ECKMONTAGE /
 DISPOSICIÓN EN ESQUINA

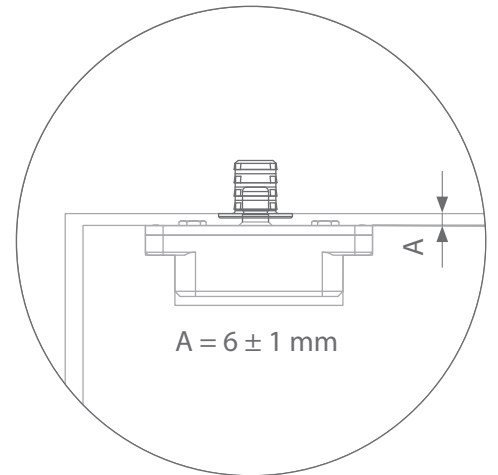
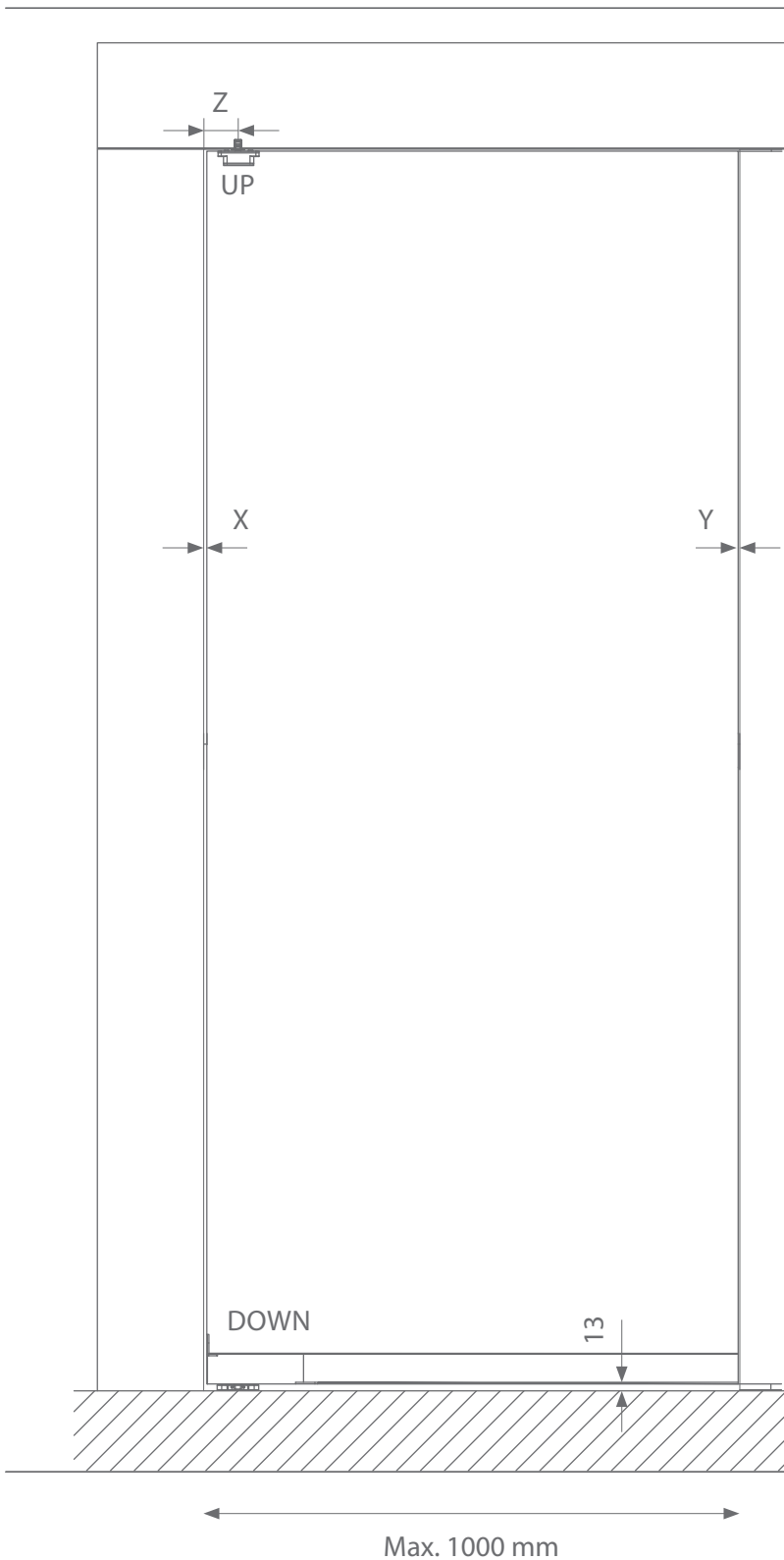

**LINTEEL MONTAGE / MONTAGE SOUS LINTEAU /
 LINTEL MOUNT / MONTAGE IM STURZ / MONTAJE DINTEL**

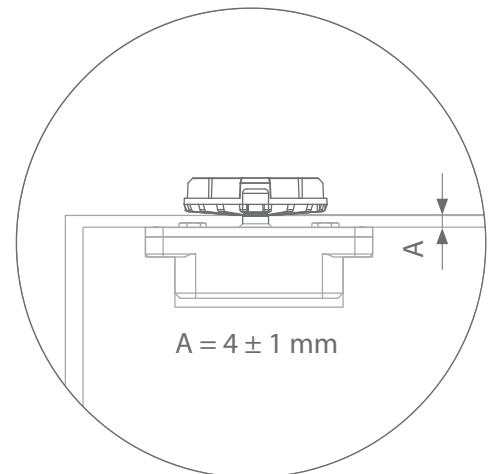

**PLAFONDBEVESTIGING / MONTAGE AU PLAFOND / CEILING
 MOUNT / DECKENMONTAGE / FIJACIÓN EN TECHO**

Deur / Porte / Door / Tür / Puerta	X	Y	Z
--	---	---	---

40 mm	6 mm	3 mm	64,5 mm
45 mm	6 mm	3 mm	64,5 mm
50 mm	7 mm	3 mm	65,5 mm
54 mm	8 mm	3 mm	66,5 mm

1. DEURBLAD VOORBEREIDEN / PREPARATION DU VANTAIL / PREPARATION DOOR LEAF / TÜRBLATTVORBEREITUNG / PREPARACIÓN DE LA HOJA DE LA PUERTA

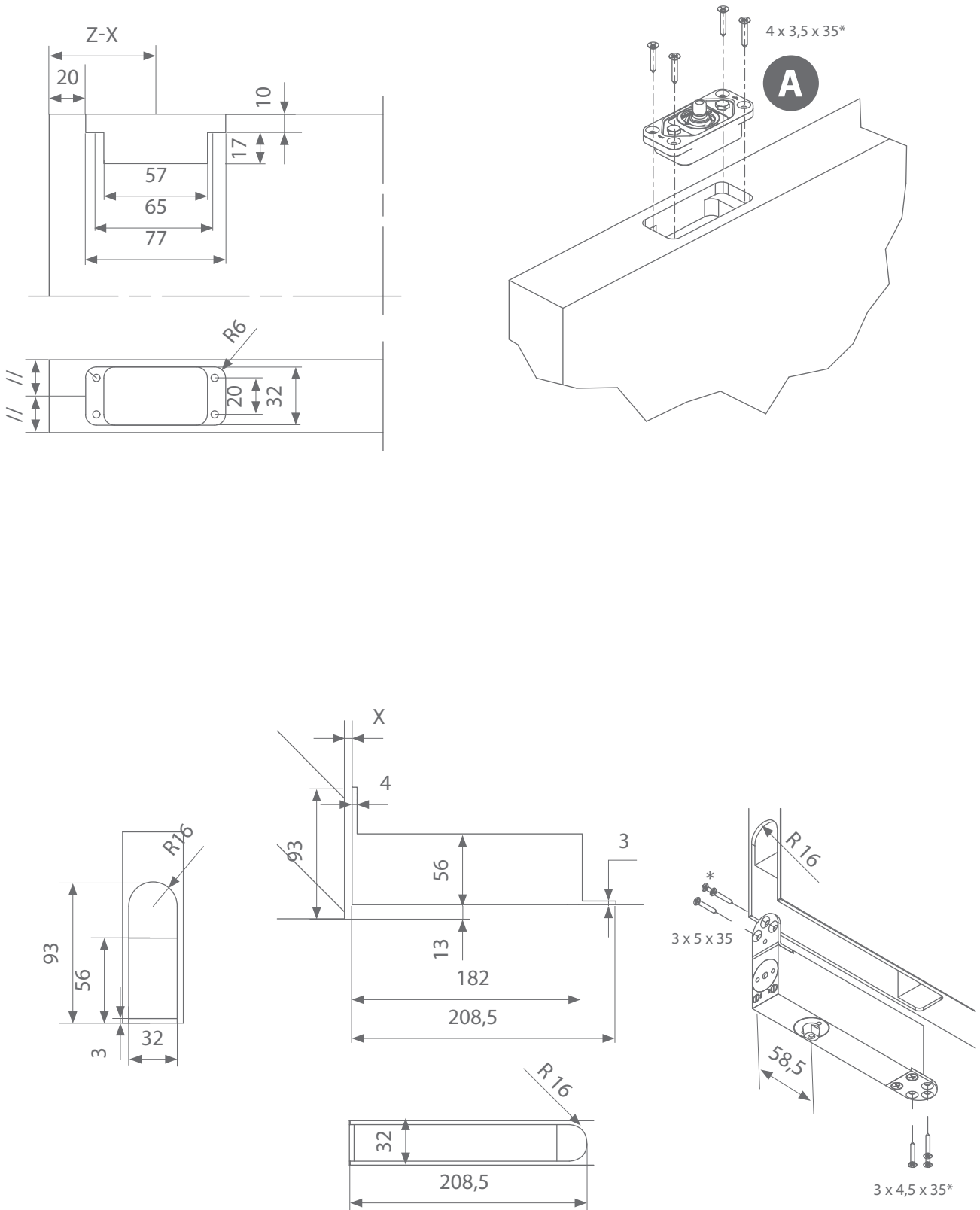

* schroeven niet meegeleverd - les vis ne sont pas inclus - screws not included - Schrauben nicht mitgeliefert - tornillos no incluidos / aanbevolen schroefmaat - taille de vis recommandée - recommended screw size - empfohlene Schraubengröße - tamaño de tornillo recomendado

3A. LINTEEL MONTAGE / MONTAGE SOUS LINTEAU / LINTEL MOUNT / MONTAGE IM STURZ / MONTAJE DINTEL

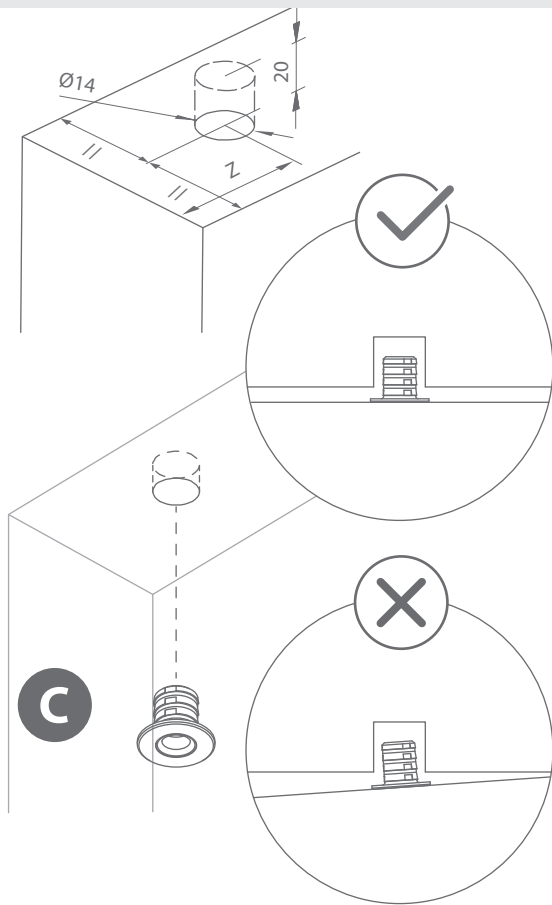

3B. PLAFONDBEVESTIGING / MONTAGE AU PLAFOND / CEILING MOUNT / DECKENMONTAGE / FIJACIÓN EN TECHO

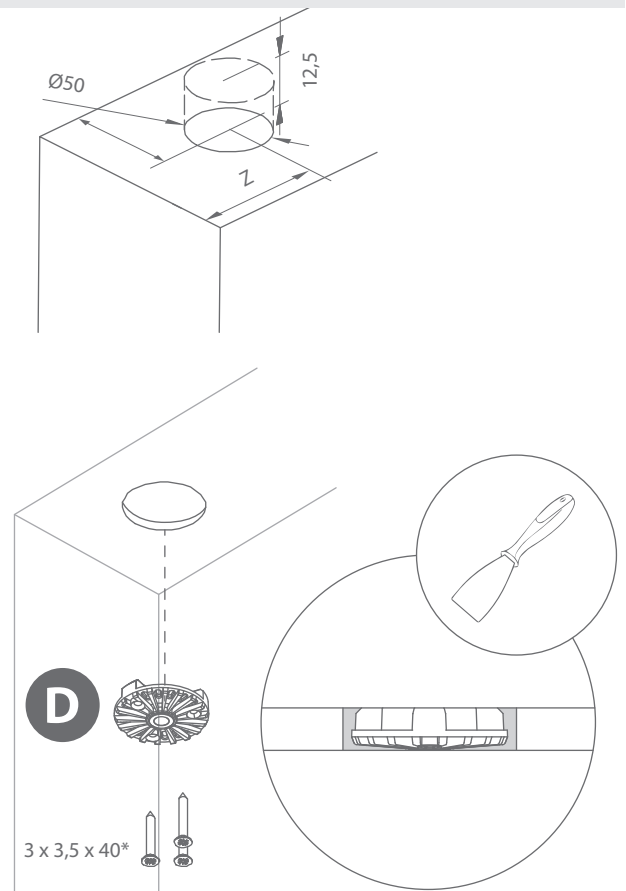

4. MONTAGE VLOERPLAATJE / MONTAGE DE LA PLAQUETTE AU SOL / MOUNTING OF SURFACE FLOOR PLATE / MONTAGE DER AUFBODENPLATTE / PLACA DE SUELO DE MONTAJE

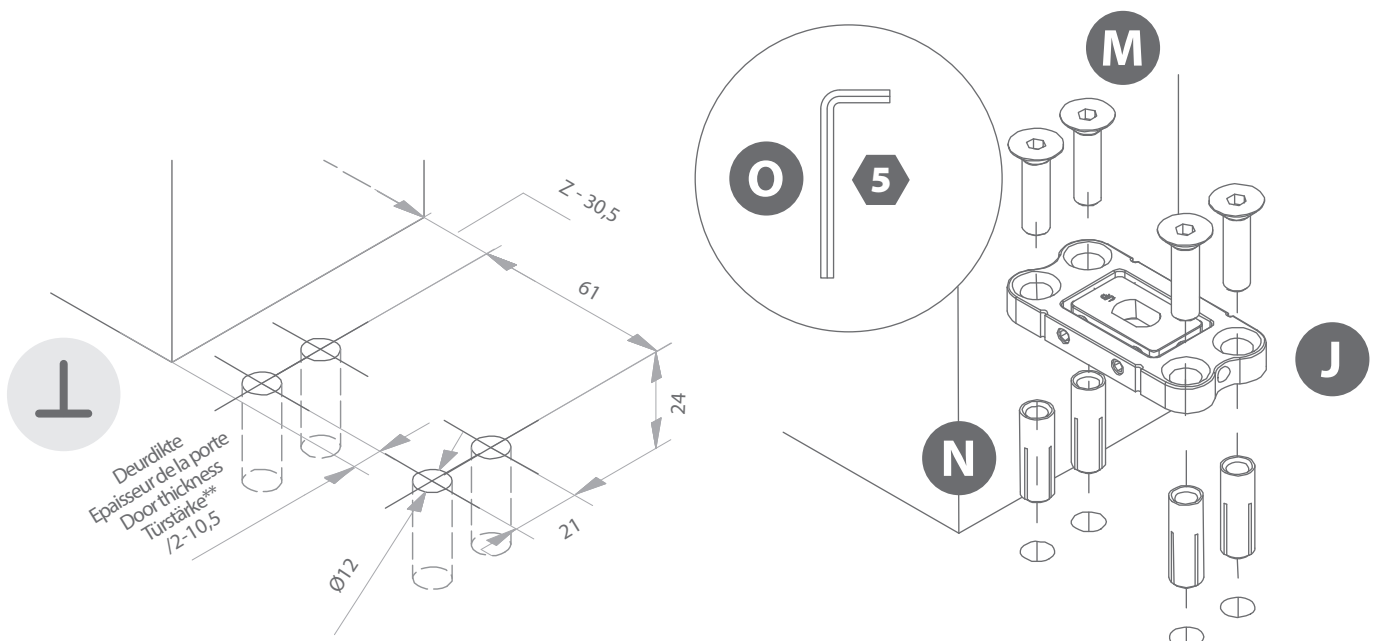

5. AFREGELLEN VLOERPLAAT EN PIVOT / RÉGLER LA PLAQUE DE SOL ET DU PIVOT / ADJUSTING FLOOR PLATE AND PIVOT / BODENPLATTE UND PIVOT EINSTELLEN / AJUSTE DE LA PLACA DEL SUELO Y DEL PIVOT

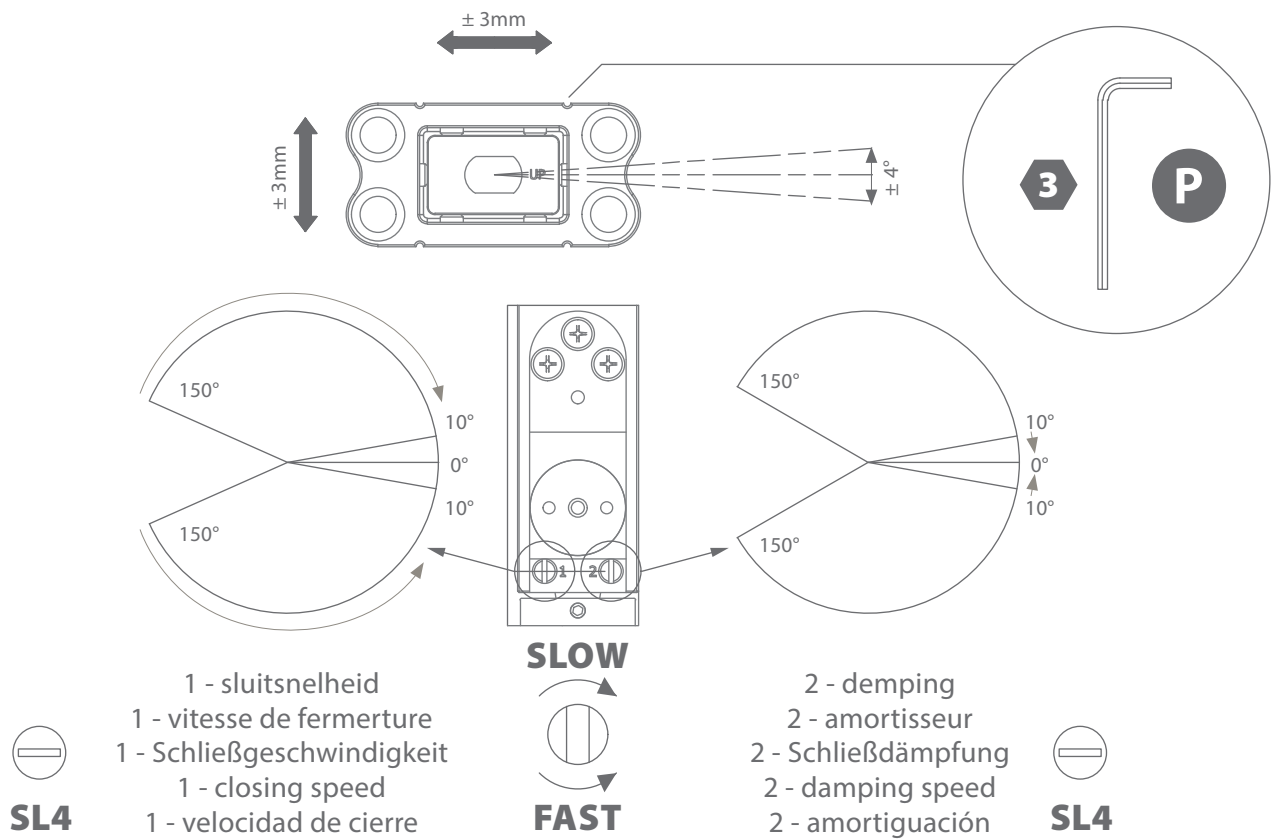

6. AFDEKPLAATJES BEVESTIGEN / FIXATION DES CACHES / MOUNTING OF COVER PLATES / BEFESTIGUNG DER ABDECKKAPPEN / FIJACIÓN DE LAS TAPAS

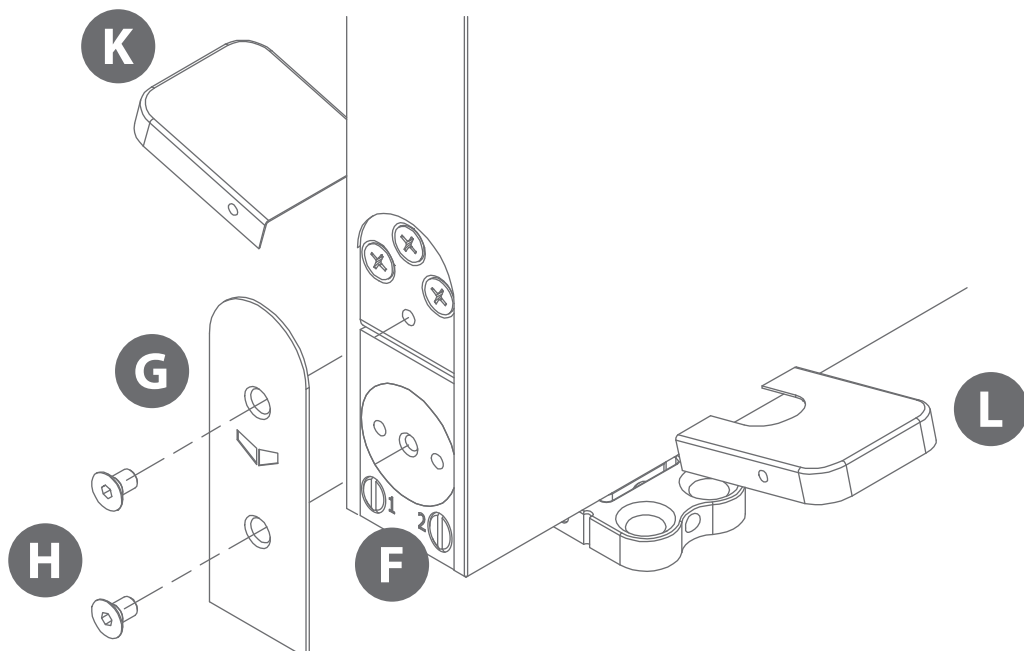

7. MONTAGE DEURBLAD / POSE DU VANTAIL DE PORTE / MOUNTING DOOR LEAF / TÜRBLATTMONTAGE / MONTAJE DE LA HOJA DE LA PUERTA

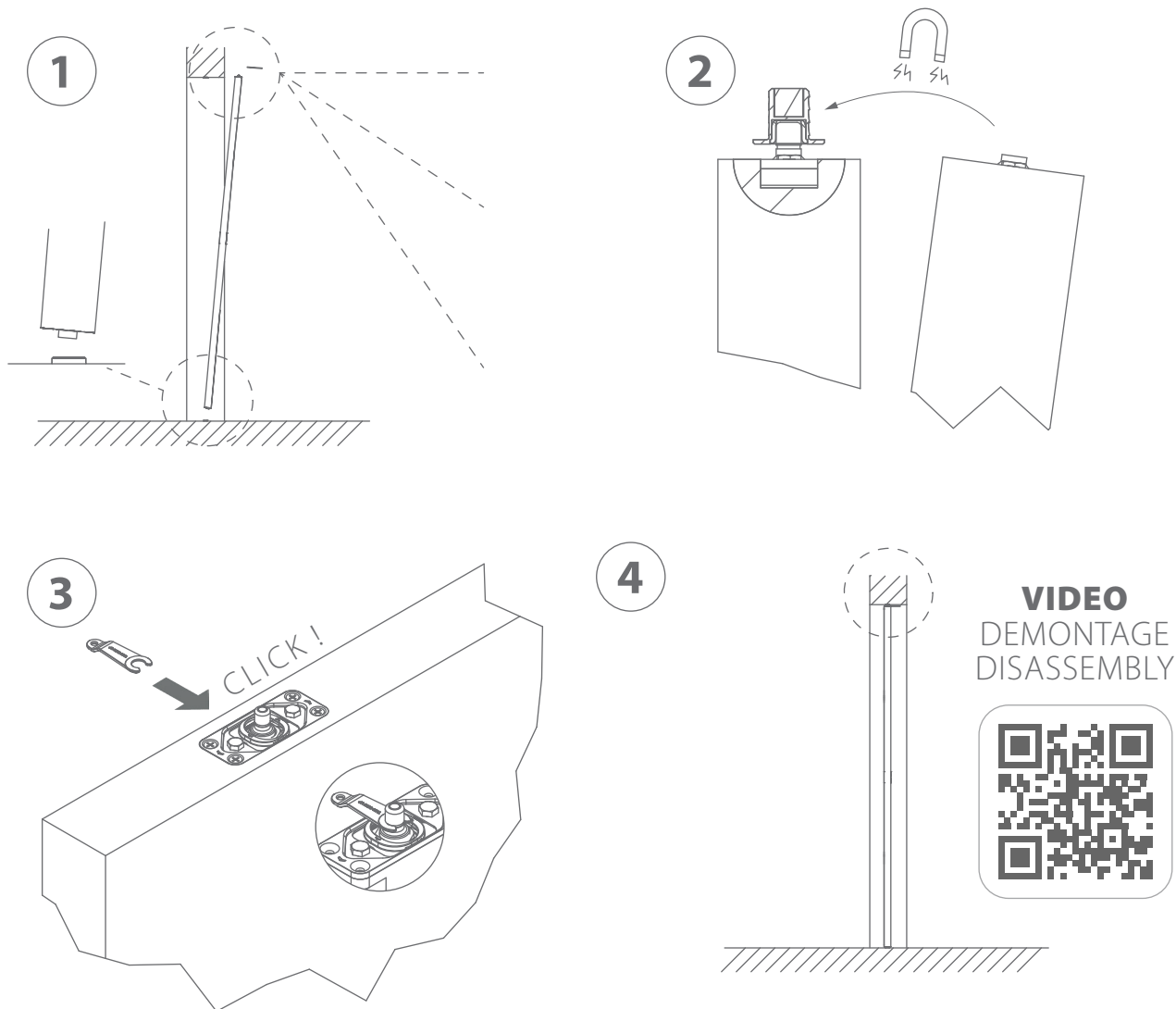

8. AFREGELLEN BOVENSPEUN / RÉGLAGE DU PIVOT SUPÉRIEUR / ADJUSTMENT OF TOP PIVOT / EINSTELLEN DER OBEREN PIVOT / AJUSTE DE LA BISAGRA SUPERIOR

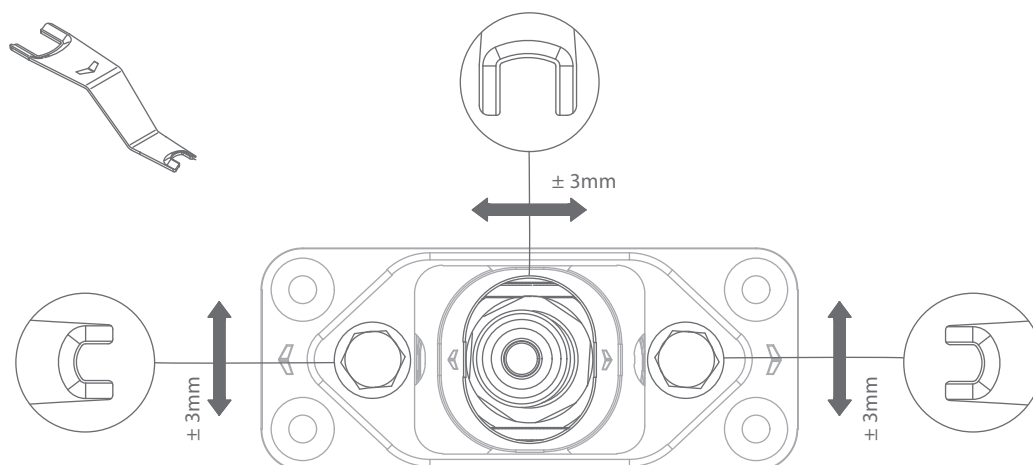

(DE)CENTRALE OPSTELLING/ POSITION (DÉ)CENTRALE / (DE)CENTRAL POSITION / (DE)ZENTRALE POSITION / DISPOSICIÓN (DES)CENTRALIZADA

Groeven op pivotica® pro af te stellen
 Rainures pour régler pivotica® pro
 Grooves to set pivotica® pro
 Rillen zum Einstellen von Pivotica® Pro
 Ranuras para ajustar la pivotica® pro

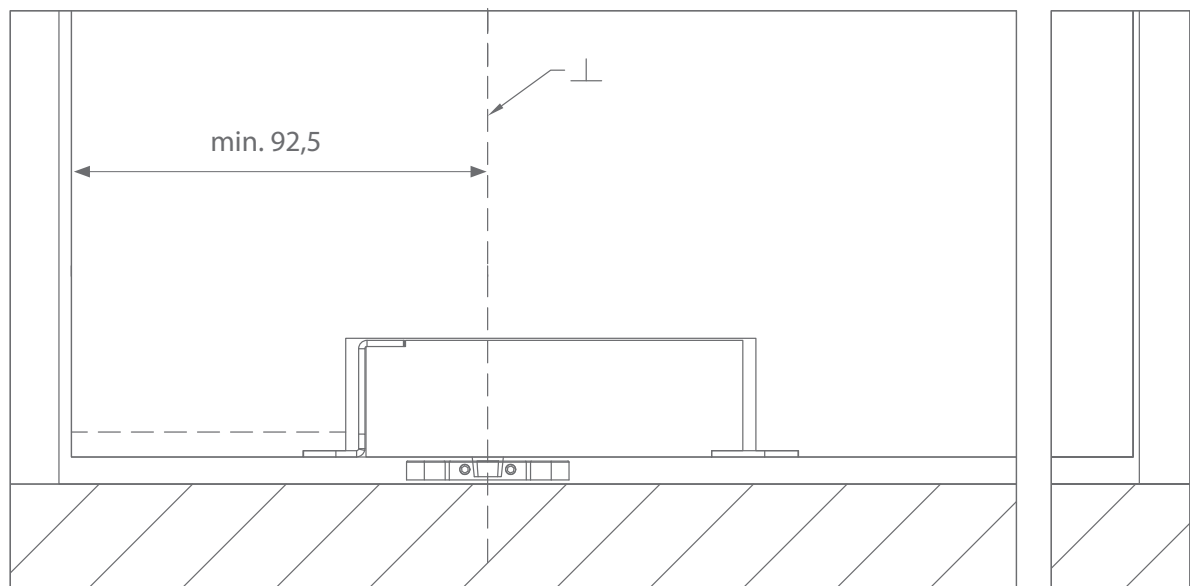
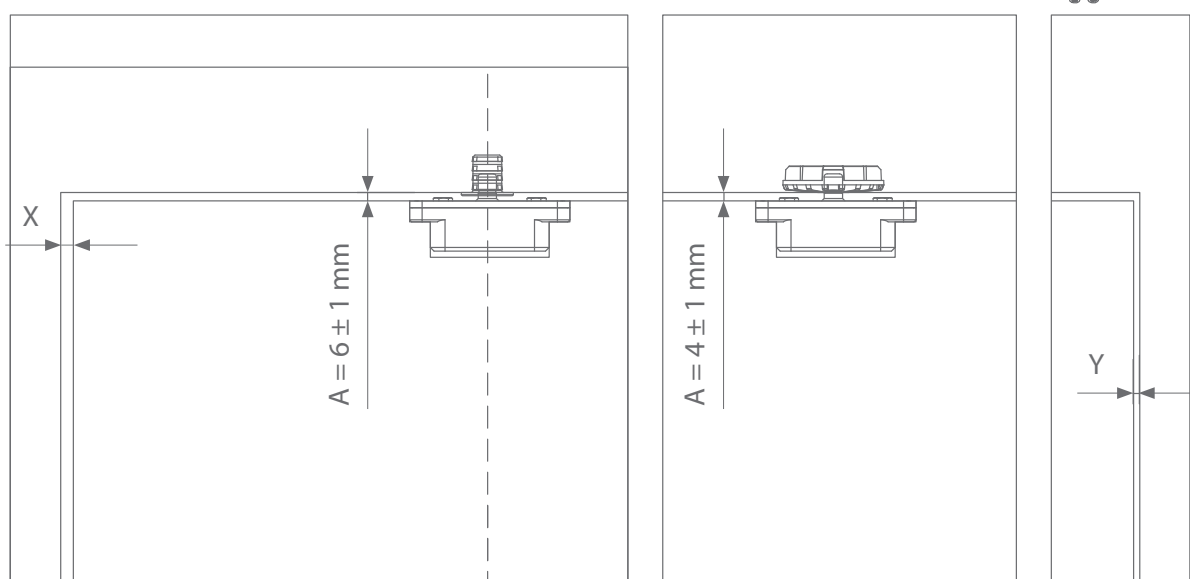
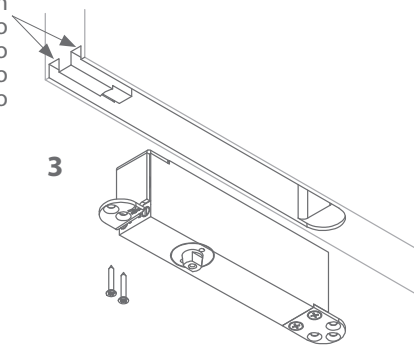
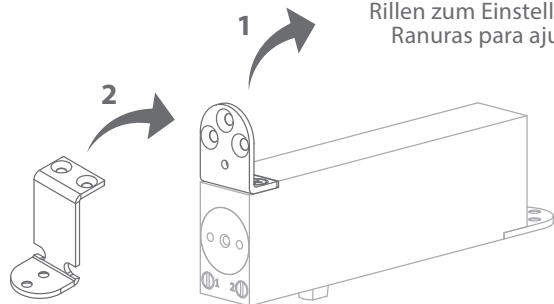

X = 4 mm
 Y = 3 mm

Max. 2000 mm